

**NOTES**

1. THIS TOPOGRAPHIC AND BOUNDARY SURVEY WAS PERFORMED IN APRIL 2004 BY KEYSTONE CONSULTING ENGINEERS, INC. USING A TOPCON GTS-38 TWO SECOND TOTAL STATION AND A TOPCON HIFERTRK GLOBAL POSITIONING SYSTEM.
2. THIS PLAN REPRESENTS THE LOCATION OF OBVIOUS ABOVEGROUND IMPROVEMENTS. CERTAIN UNDERGROUND LINES HAVE BEEN LOCATED FROM PLANS ON PUBLIC RECORD AND HAVE NOT BEEN FIELD VERIFIED. UNDERGROUND UTILITY LINES, WIRING, ETC. NOT EXHIBIT IN THE FIELD HAVE NOT BEEN SHOWN.
3. IN ACCORDANCE WITH THE PROVISIONS OF ACT 187/287, THE CONTRACTOR SHALL VERIFY UNDERGROUND UTILITIES PRIOR TO EXCAVATION.
4. FOR DETAILS OF "M" & "C" TYPE INLETS, MANHOLES AND FLARED END SECTIONS SEE PLOT STANDARDS FOR ROADWAY CONSTRUCTION. USE STANDARD INLET BOX WITH TYPE "M" OR "C" CONCRETE INLET FRAME WITH A STRUCTURAL STEEL BICYCLE SAFE GRATE.
5. SICPP INDICATES SMOOTH INTERIOR (N-12) CORRUGATED POLYETHYLENE PIPE & FITTINGS AS MANUFACTURED BY ADVANCED DRAINAGE SYSTEMS, INC. OR AN EQUAL.
6. "SDR35" INDICATES TYPICAL NON-PRESSURE PVC PIPE.
7. "E.W." INDICATES STANDARD DW TYPE ENDWALL (SEE PLOT STANDARDS FOR ROADWAY CONSTRUCTION FOR DETAILS). ENDWALLS SHALL BE FITTED WITH A REMOVABLE GALVANIZED TRASH RACK WITH BARS AT 6" ON CENTER.
8. AFTER CONSTRUCTION, INLET BOXES AND MANHOLES SHALL BE FILLED WITH CONCRETE UP TO THE INVERT OF THE OUTLET PIPE ELEVATION.
9. HANDICAP PARKING STALLS (SHOWN BY "HC") SHALL BE CONSTRUCTED WITH BLUE HANDICAP PAINT SWARTEL AND A 67"-8" SIGN INDICATING "HANDICAP PARKING" WITH A R7-8B FENELITES SIGN. ALL OTHER PARKING STALLS SHALL BE DESIGNATED WITH A 4" WIDE WHITE PAINT LINE. A STOP SIGN SHALL BE PLACED AT THE EXIT ONTO GARP VIEW ROAD & SHALL BE RT-1 HIGH INTENSITY STOP SIGN.

**PIPE SCHEDULE**

PIPE SIZE	MATERIAL	SOLID/PERFORATED	LF	GRADE
1-2 24"	SICPP	(SOLID)	70	2.00%
3-18 6"	SDR35	(PERF)	90	0.00%
3-30 6"	SDR35	(PERF)	90	0.00%
30- 6"	SDR35	(PERF)	8	0.00%
4-5 18"	SICPP	(SOLID)	30	1.70%
5-6 15"	SICPP	(SOLID)	175	4.40%
7-8 18"	SICPP	(SOLID)	30	2.00%
8-9 15"	SICPP	(SOLID)	100	5.00%
10- 6"	SDR35	(PERF)	30	0.00%
10- 6"	SDR35	(PERF)	30	0.00%
11-12 15"	SICPP	(SOLID)	85	1.00%
13-14 18"	SICPP	(SOLID)	140	1.00%
14-15 15"	SICPP	(SOLID)	162	1.20%
14-16 15"	SICPP	(SOLID)	110	1.50%
16-17 15"	SICPP	(SOLID)	60	1.50%
18-19 24"	SICPP	(SOLID)	200	1.70%
19-20 24"	SICPP	(PERF)	275	0.55%
20-21 18"	SICPP	(SOLID)	145	0.50%
21-22 15"	SICPP	(SOLID)	100	0.50%
22-23 15"	SICPP	(SOLID)	40	0.50%
26-25 18"	SICPP	(SOLID)	120	2.37%
28-27 15"	SICPP	(SOLID)	80	2.00%
31- 6"	SDR35	(PERF)	30	0.00%
31- 6"	SDR35	(PERF)	30	0.00%

**DRAINAGE STRUCTURE SCHEDULE**

STRUCTURE #	BOX	TOP
1	CONC. DW ENDWALL	N/A
2	STD. 2'x4" W/ OUTLET CONTROL OPENINGS	TYPE M S.S.
3	5' ROUND	TYPE M CONC.
4	CONC. DW ENDWALL	N/A
5	STD. 2'x4"	TYPE C
6	STD. 2'x4"	TYPE M CONC.
7	CONC. DW ENDWALL	N/A
8	STD. 2'x4"	TYPE C
9	STD. 2'x4"	TYPE M CONC.
10	5' ROUND	TYPE M CONC.
11	CONC. FLARED END SECTION	N/A
12	STD. 2'x4"	TYPE M CONC.
13	CONC. FLARED END SECTION	N/A
14	STD. 2'x4"	TYPE M CONC.
15	STD. 2'x4"	TYPE M CONC.
16	STD. 2'x4"	TYPE M CONC.
17	STD. 2'x4"	TYPE M CONC.
18	5' ROUND	TYPE M CONC.
19	STD. 2'x4"	TYPE M CONC.
20	STD. 2'x4"	TYPE M CONC.
21	STD. 2'x4"	TYPE M CONC.
22	STD. 2'x4"	TYPE M CONC.
23	STD. 2'x4"	TYPE M CONC.
24	CONC. FLARED END SECTION	N/A
25	STD. 2'x4"	TYPE M CONC.
26	CONC. DW ENDWALL	N/A
27	STD. 2'x4" W/ OUTLET CONTROL OPENINGS	TYPE M S.S.
28	CONC. DW ENDWALL	N/A
29	5' ROUND	TYPE M CONC.
30	5' ROUND	TYPE M CONC.

**NOTES:**

1. "STD. 2'x4" INLET BOXES SHALL BE STANDARD PLOT PRECAST INLET BOXES IN ACCORDANCE WITH COMMONWEALTH OF PENNA. DOT BUREAU OF HIGHWAY DESIGN, STANDARDS FOR ROADWAY CONSTRUCTION SERIES RC 34.
2. "5' ROUND" INLET BOX INDICATES 60" DIAMETER MANHOLE BOTTOM SECTION WITH 8" THICK REINFORCED CONCRETE TOP CONSTRUCTED TO PENNDOT IN-20 LOADING SPECIFICATIONS. TOP TO HAVE 24"X45" OPENING TO ACCOMMODATE A STANDARD PENNDOT TYPE M STRUCTURAL STEEL INLET FRAME & GRATE.
3. "TYPE M S.S." INLET FRAMES SHALL BE PENNDOT STRUCTURAL STEEL INLET FRAMES WITH BICYCLE SAFE STRUCTURAL STEEL GRATES IN ACCORDANCE WITH COMMONWEALTH OF PENNA. DOT BUREAU OF HIGHWAY DESIGN, STANDARDS FOR ROADWAY CONSTRUCTION SERIES RC 34.
4. "TYPE M CONC." INLET FRAMES SHALL BE PENNDOT STRUCTURAL CONCRETE INLET FRAMES WITH BICYCLE SAFE STRUCTURAL STEEL GRATES IN ACCORDANCE WITH COMMONWEALTH OF PENNA. DOT BUREAU OF HIGHWAY DESIGN, STANDARDS FOR ROADWAY CONSTRUCTION SERIES RC 34.

**LEGEND**

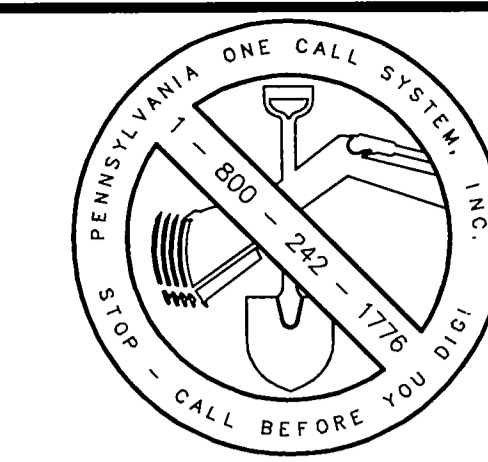
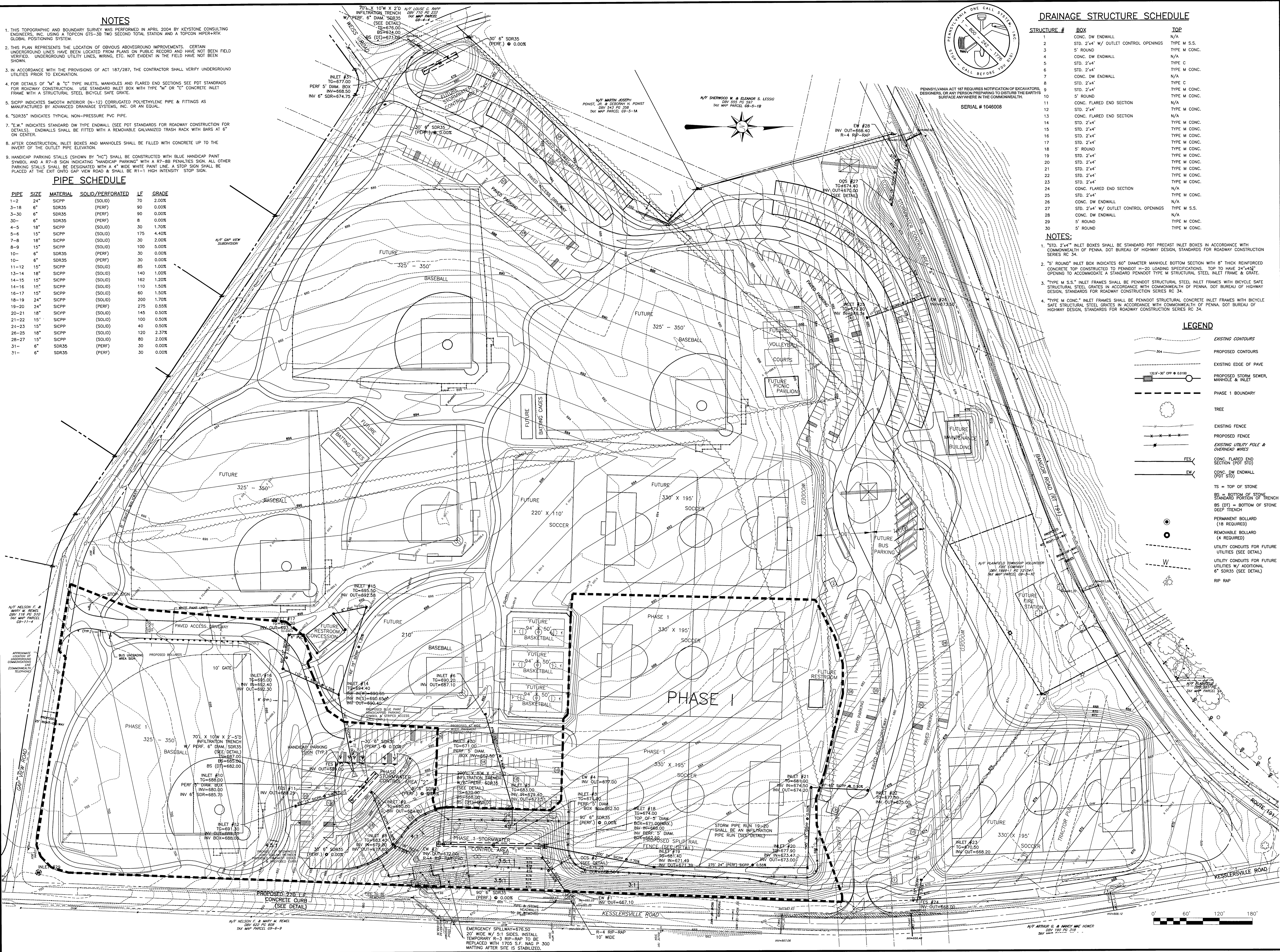
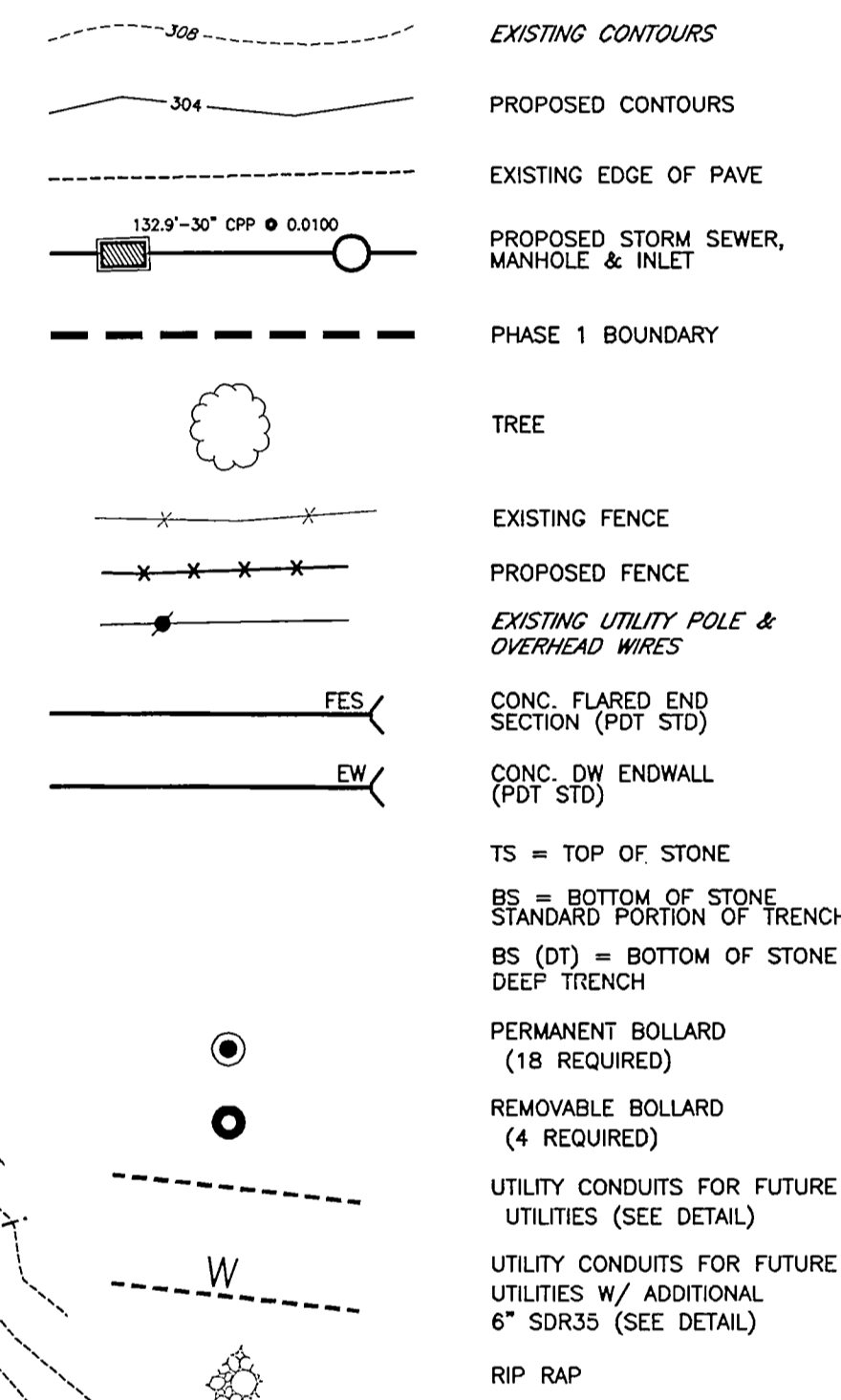

**KEYSTONE CONSULTING ENGINEERS, INC.**  
 433 EAST BROAD STREET, BETHLEHEM, PA. 18018 610-865-4555  
 6235 HAMILTON BOULEVARD, WESCOVILLE, PA. 18106 610-395-0971



OVERALL SITE PLAN FOR THE  
**PLAINFIELD COMMUNITY PARK PHASE I**  
 IN  
 PLAINFIELD TOWNSHIP, NORTHAMPTON COUNTY, PENNSYLVANIA

REV.	DATE	DESCRIPTION

DTG. NO. : PT-04-009  
 SCALE : 1" = 60'  
 DWN. BY : ARK, LMK  
 DATE : AUGUST 18, 2004  
 SHEET 5 OF 8